

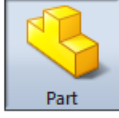
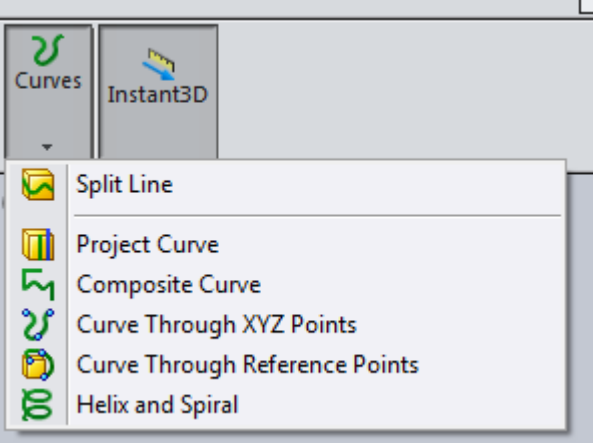

# PERVANE ÇİZİMİ

1. Solidworks programı açılır.

2.  ' e tıklanır ve çizim sayfası olarak  seçilir.

3.  seçeneğine tıklanır.

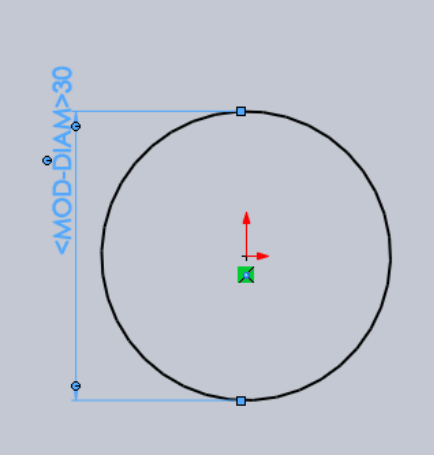
4.  tıklanarak  de bir çizim açmış oluruz.

5.  +  onaylayın.

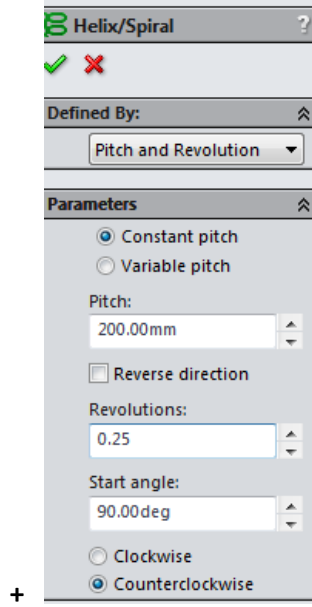
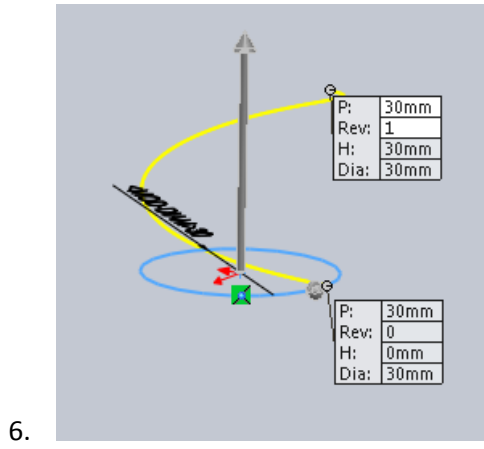

ölçüleri verilir.

7. Skech +  Top Plane seçilir.

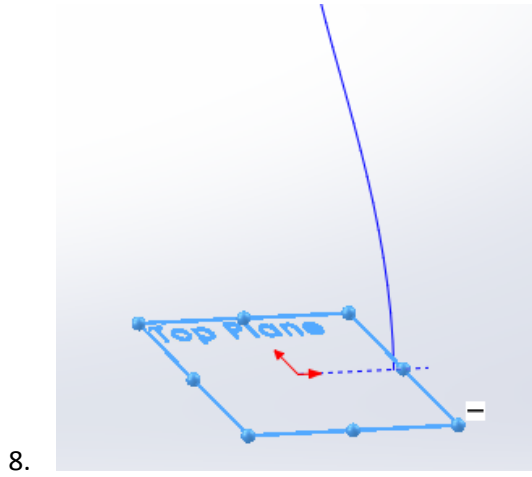

eksenden geçecek şekilde bir çizgi çizilir.

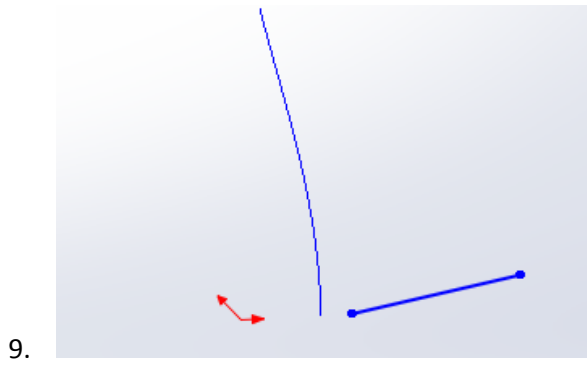

10.

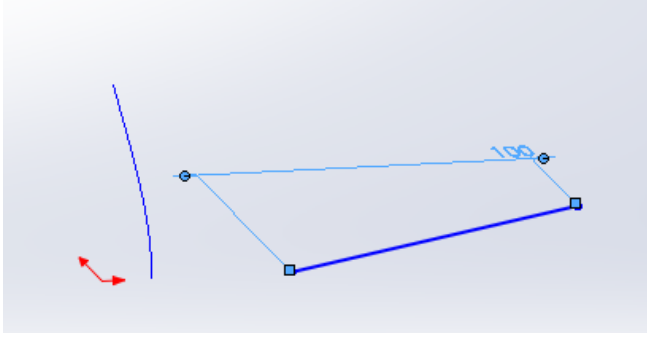

ölçüsü verilir.

11.



+

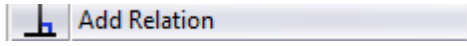

seçeneği seçilir.

12.

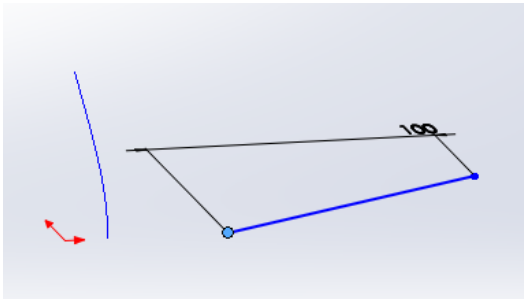

yatay çizginin ucu ve dik çizginin kendisi seçilir.

13.

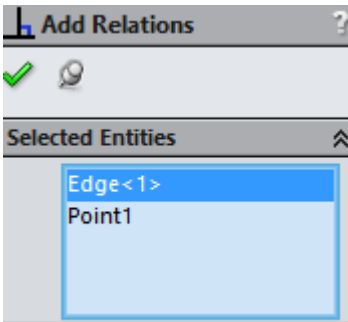

olacak şekilde ve

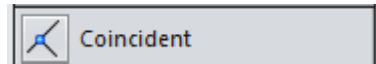

seçilir.

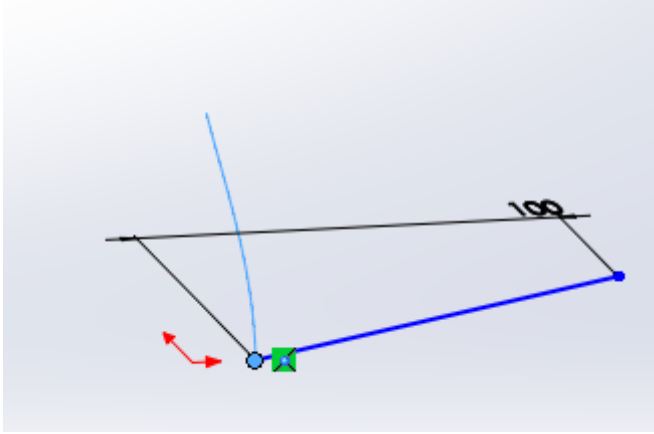

14.

Bu şekilde uçları birleşmiş olacak.



15.

ile onayladıktan sonra

Surfaces

+

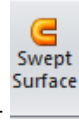

seçilir.

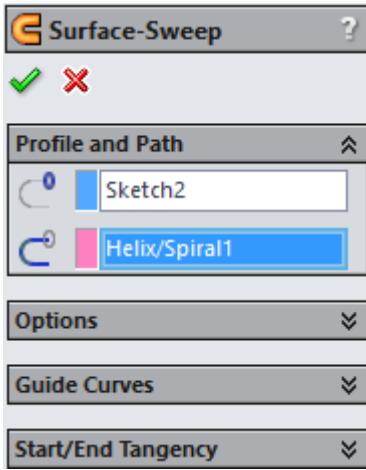

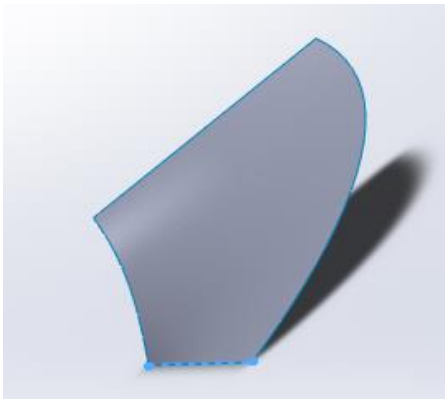

16.

seçilip onaylanır.



17.

bu şekilde ilk kanadımız oluşmaktadır.

18. Daha sonra;  File Edit View Insert Tools Window Help +  
Insert + Boss/Base +  Thicken... seçilir.

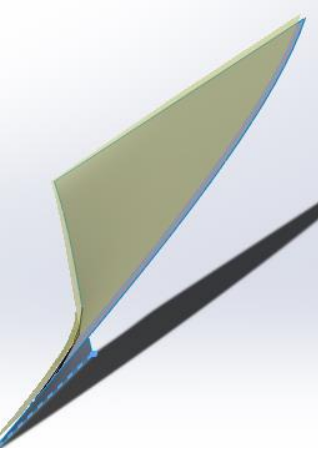
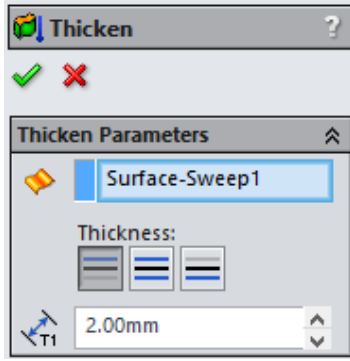
19.   kanadımızı kalınlaştırmış oluruz.

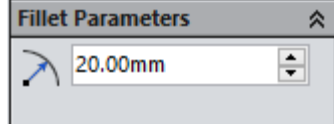
20.  seçilerek  ölçüsü verilir.

21.  olacak şekilde iki sağ ve sol iki uç nokta seçilir.

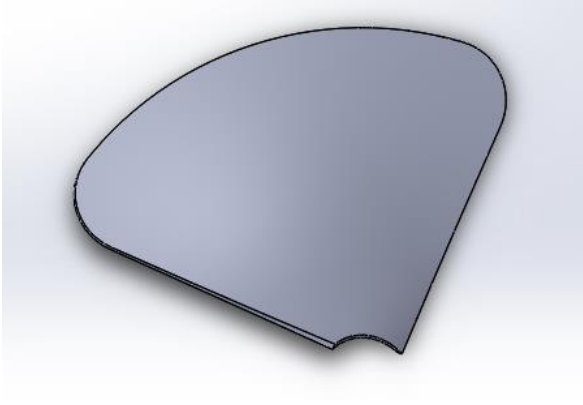

kanadımız bu hali alır.

22.  Top Plane 'de Sketch açılır.

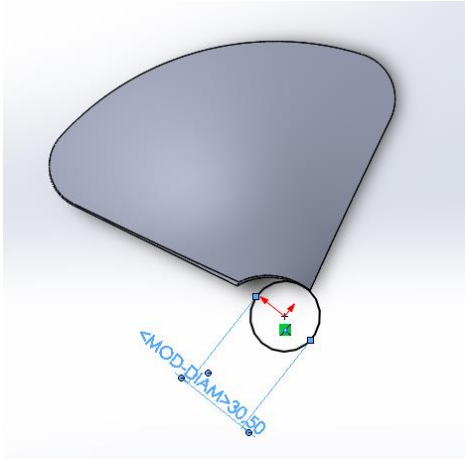

23. (merkezden 30.5 ölçüsünde daire çizilir ve onaylanır.)

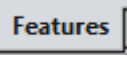
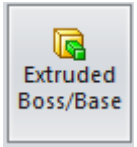
24.  +  seçilir.

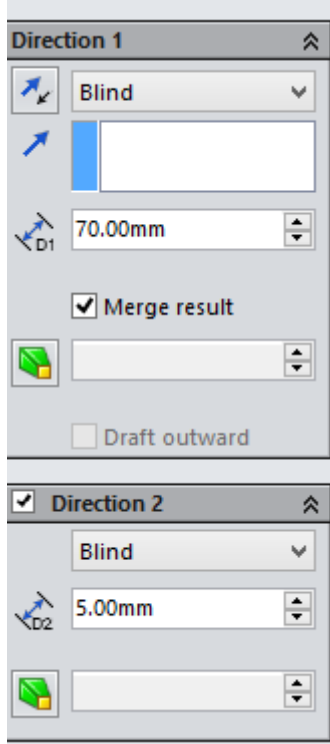

25. ölçüleri verilip onaylanır.

26.

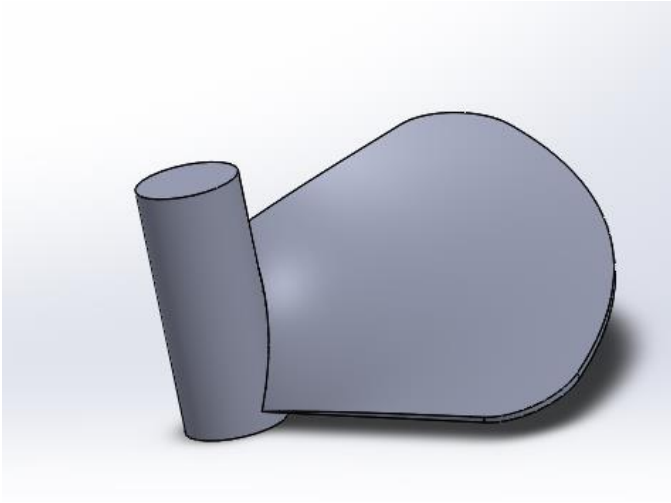

bu şekile gelir.

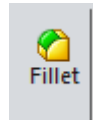

27. Daha sonra seçilir.

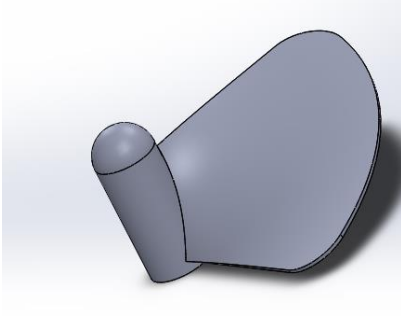

28.

15 mm filletlenir.



29. Tekrardan seçilir.

30.

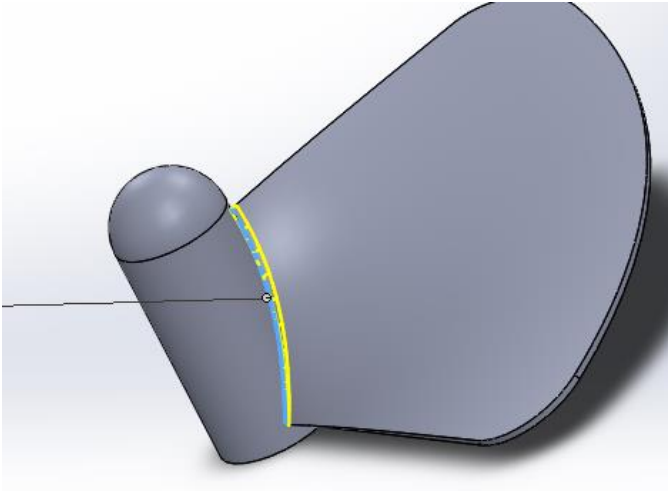

gösterilen yer) filletlenir.

2 mm kanadın köşesinden (sarı ile

31. Aynı şekilde kanadın alt tarafıda 2 mm filletlenir.

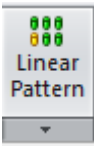

32.

+



Circular Pattern

seçilir.



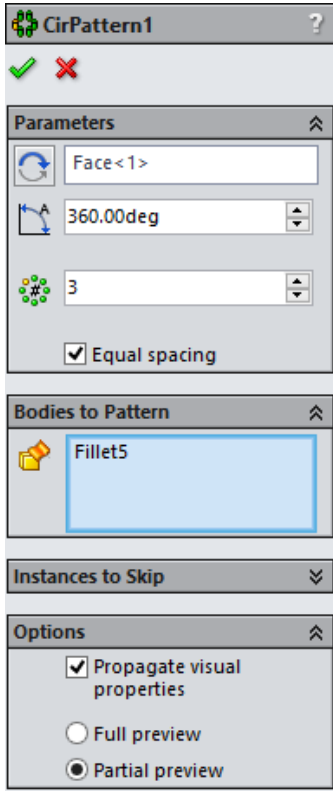

33. ayarları verilip onaylanır.

34. Ve bu şekilde pervanemiz bitmiş oluyor.

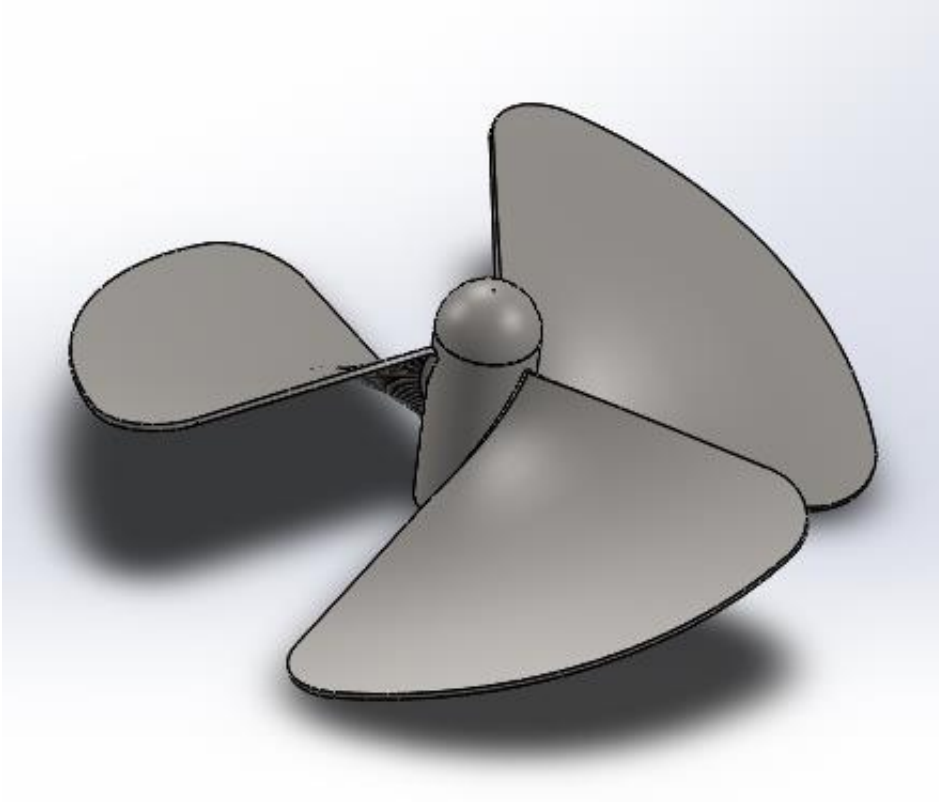

35.

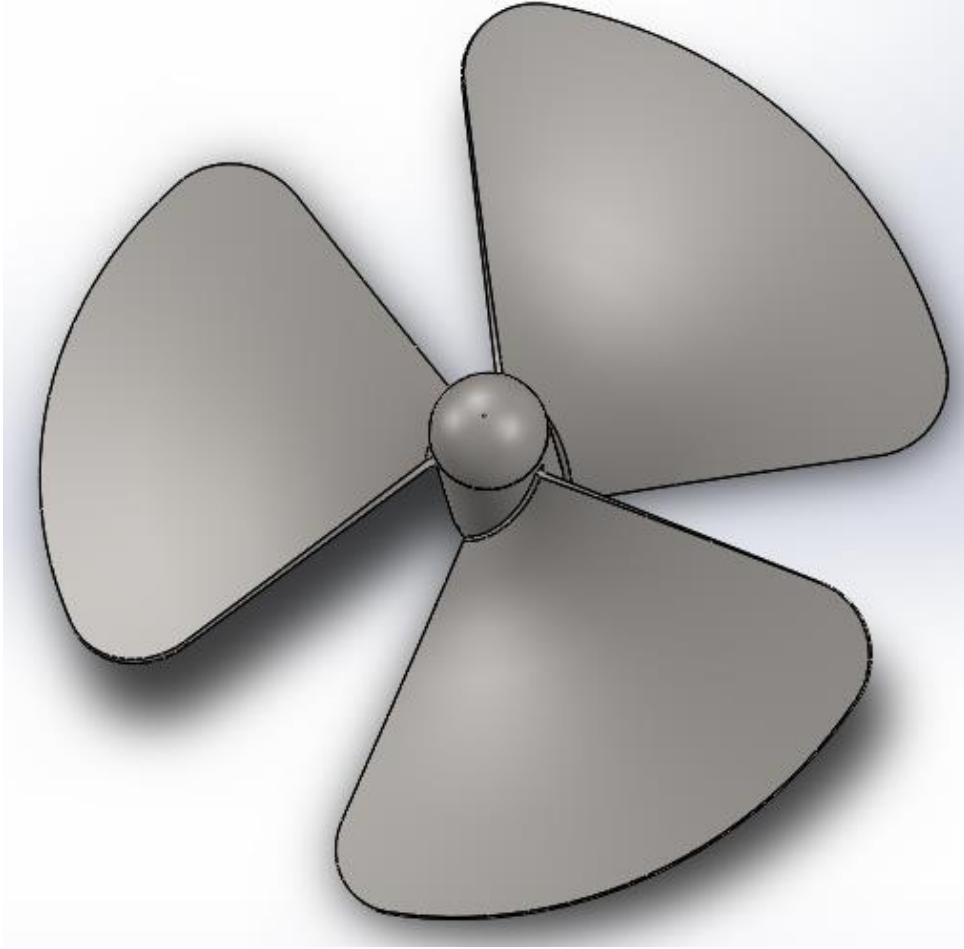

**FATMA DARBAZ**

**MK2 360613011**